

SALE

LAB BUILDING

Presented by Patterson-Woods & Associates

“The Area’s Leading Commercial Broker”

235 Cherry Lane NEW CASTLE, DE 19720

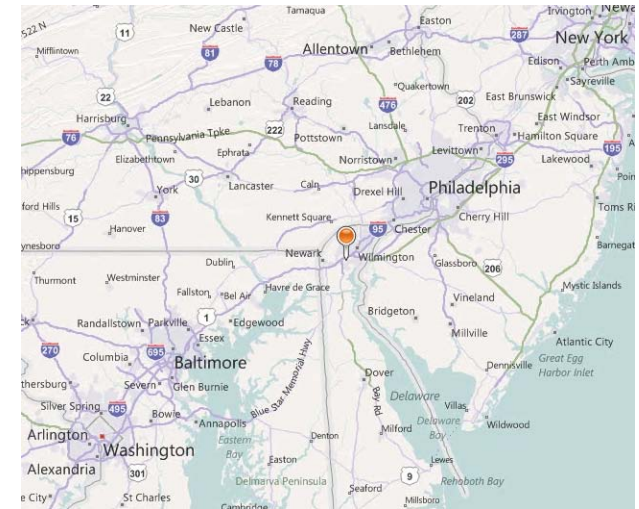

- Arch Chemical water testing laboratory
- Approximately 14,000 sq ft building on one acre
- Turn key opportunity: Furniture & cabinets avail
- Like new condition
- Mid way between New York and Wash DC
- Similar adjoining lab & pilot plant also available
- Power and steam feeds available
- Price: \$1,950,000 (Under \$140/sq ft furnished!)

Call Charles Woods, SIOR 302-622-3505

Michael Woods 302-622-3565

CORFAC
International

**PATTERSON
WOODS**
COMMERCIAL PROPERTIES

3801 Kennett Pike D-100

Greenville Center

Wilmington, Delaware 19807

302-622-3500 800-220-2738

Email: info@pattersonwoods.com

Web Site: www.pattersonwoods.com



The above information is believed to be accurate but the users must verify it for their own satisfaction. Price and availability is subject to change without prior notice. The Seller's broker, any cooperating broker, and any salesperson working with either, are representing the Seller's interests and have fiduciary responsibilities to Seller, but are obligated to treat all parties fairly.



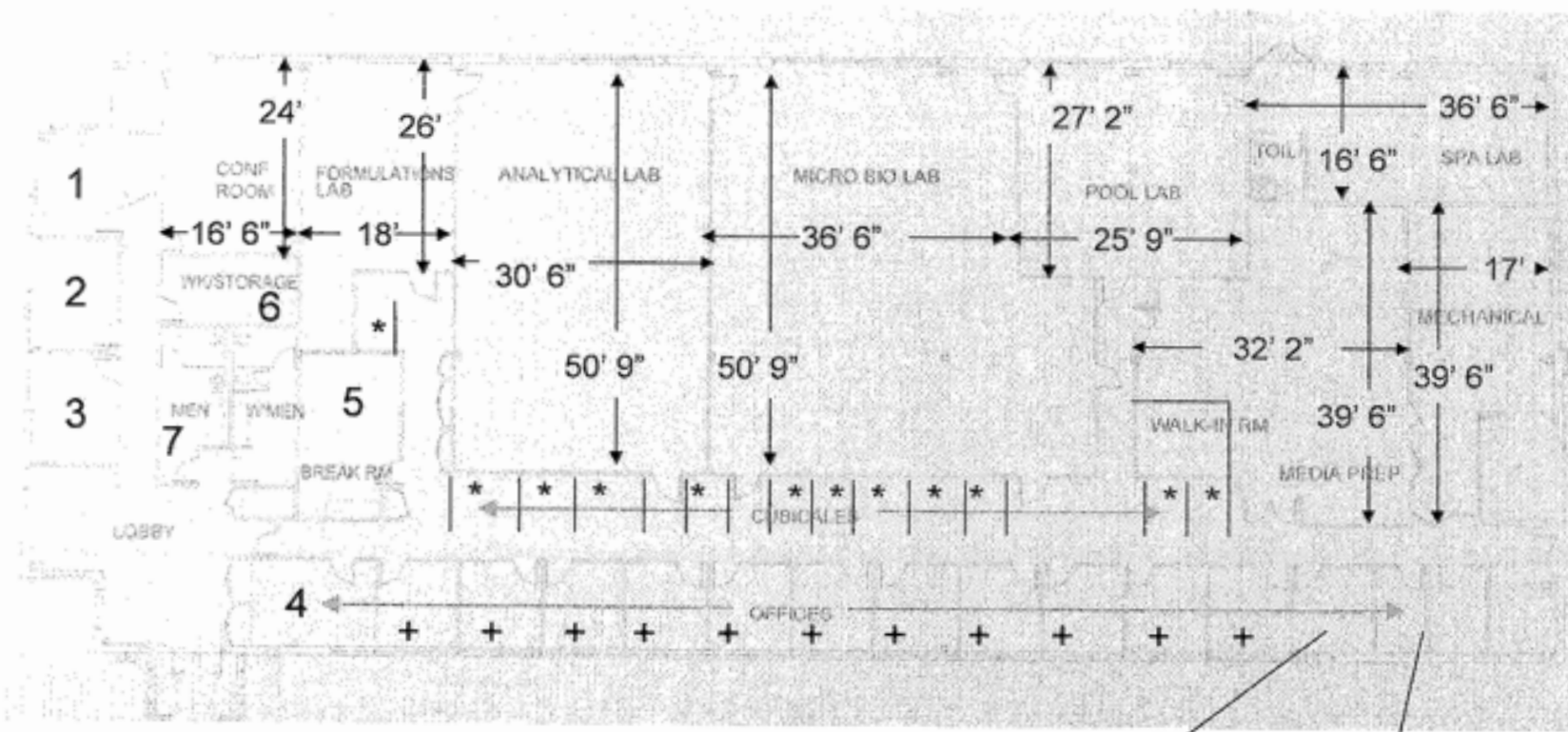

+Professional Office 9'6" x 10'6"

*Technician Cubicle 6'6" x 5'6"

¹Office A 13' x 10'6"

²Office B 13'6" x 10'6"

³Office C 13'6" x 10'6"

⁴Intern Room 14' x 10'6"

⁵Break Room 12' x 18'4"

⁶Archive Room 16'6" x 8'6"

⁷Bathroom 7'6" x 19'6"

Server Room 9'6" x 10'6"

Communications Closet 9'6" x 10'6"
& Electrical Room

14,000 sq. foot R&D Facility



Lab Pictures